

VICINITY MAP

NOTES:

THE SUBJECT PROPERTY IS PARTIALLY LOCATED IN SPECIAL FLOOD HAZARD AREA 'A' PER F.I.R.M. NO. 21059C0155D & NO. 21059C0160D REVISED APRIL 16, 2009.

THE PROPERTY DESCRIBED HEREON IS SUBJECT TO ALL LEGAL EASEMENTS AND RIGHTS-OF-WAY THAT MAY OR MAY NOT BE OF RECORD.

THIS PLAT AND SURVEY REPRESENTED HEREON COMPLIES WITH 201 KAR 18:150.

THE BOUNDARY SURVEY REPRESENTED HEREON WAS PERFORMED BY APPROXIMATELY 60% USING TRIMBLE GPS R8 GNSS MODEL 3, DUAL FREQUENCY RECEIVERS BY REAL TIME KINEMATIC WITH A RELATIVE POSITIONAL ACCURACY OF 0.05 FEET USING GEOID MODEL 09 WITH KENTUCKY SOUTH 1602 AND NAVD 1983.

TRACT 1 AND TRACT 2 ARE EXISTING LOTS OF RECORD. TRACT 3, 4, 5, 6, 7 & 8 ARE DEEMED TO BE AGRICULTURAL DIVISIONS.

ZONED: A-R

CHARLES W. DAWSON, JR.
PAMELA DAWSON
D.B. 710, PG. 349
PARCEL NO. 109-46-2
ZONED: A-R

OMPC APPROVAL

APPROVED: *[Signature]*
Director

DATE: 7/25/19

OWNER'S CERTIFICATION

I (WE), THE UNDERSIGNED OWNER(S) OF THE REAL ESTATE SHOWN AND DESCRIBED HEREON, DO HEREBY CERTIFY THAT I HAVE LAID-OFF, PLATTED AND SUBDIVIDED AND DO HEREBY LAY-OFF, PLAT AND SUBDIVIDE SAID REAL ESTATE IN ACCORDANCE WITH THE WITHIN PLAT, AND DO HEREBY ACCEPT THIS SURVEY, ALL STREETS AND ALLEYS SHOWN AND NOT HERETOFORE DEDICATED ARE HEREBY DEDICATED TO THE PUBLIC.

SIGNED: *[Signature]*

[Signature]

CHARLES W. DAWSON, JR.
PAMELA DAWSON
D.B. 710, PG. 349
PARCEL NO. 109-68
ZONED: A-R

LARRY SMEATHERS
DEBRA L. SMEATHERS
D.B. 440, PG. 382
PARCEL NO. 109-47
ZONED: A-R

CHARLES R. HAYDEN
CAROL K. HAYDEN
D.B. 576, PG. 742
PARCEL NO. 109-19
ZONED: A-R

WILLIAM J. MILES
KIMBERLY M. MILES
D.B. 619, PG. 133
PARCEL NO. 109-18
ZONED: A-R

KYLE W. McPHERSON
KRYSTINA L. BROWN
D.B. 881, PG. 443
PARCEL NO. 109-17
ZONED: A-R

BETHLEHEM METHODIST
CHURCH & CEMETERY
D.B. 534, PG. 254
P.B. 13, PG. 46
PARCEL NO. 109-20
ZONED: A-R

MICHAEL S. ATHERTON
CARLA A. ATHERTON
D.B. 863, PG. 861
P.B. 41, PG. 112
PARCEL NO. 109-21-1
ZONED: A-R

ERIC L. CASTLEN
DANA CASTLEN
D.B. 976, PG. 320
P.B. 44, PG. 193
PARCEL NO. 109-15
ZONED: A-R

ERIC L. CASTLEN
DANA C. CASTLEN
D.B. 937, PG. 627
PARCEL NO. 109-14
ZONED: A-R

OWNER/CLIENT
FRANKLIN DUNCAN
P.O. BOX 12199
LEXINGTON, KY 40581

RECORD SOURCE
DEED BOOK 349, PAGE 327

GRAPHIC SCALE

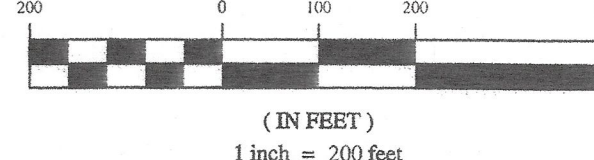

(IN FEET)
1 inch = 200 feet

FRANKLIN P. DUNCAN

PROPERTY SURVEY & DIVISION
LOCATED ON FREE SILVER ROAD,
YELVINGTON-KNOTTSVILLE ROAD
& HIGHWAY 1389
DAVISS COUNTY
MACEO, KENTUCKY

06-03-2019

DRAWN BY: BRJ

FILED IN: 887A/09/00/00000000



1535 FEDERICA STREET - P.O. BOX 21382
OWENSBORO, KENTUCKY 42304
(270) 685-2811

LEGEND

- 5/8" REBAR, 18" IN LENGTH, SET W/ CAP, P.L.S. NO. 2813
- 5/8" REBAR, 18" IN LENGTH, SET W/ CAP, "WITNESS MONUMENT"
- 1/2" REBAR FOUND W/ CAP, P.L.S. NO. 2643
- 5/8" REBAR FOUND W/ CAP, P.L.S. NO. 2552
- 1/2" REBAR FOUND
- 3/4" REBAR FOUND W/ CAP, P.L.S. NO. 1874
- 5/8" REBAR FOUND
- 1/2" IRON PIPE FOUND
- 1" IRON PIPE FOUND
- PLANTED STONE FOUND
- FENCE POST
- CALCULATED POINT (NO MONUMENT SET OR FOUND)

FLOOD ZONE 'A'

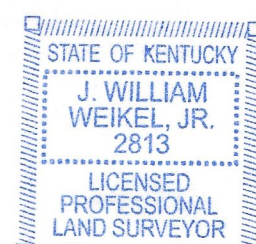

LINE	BEARING	LENGTH
L1	S 46°23'42" E	805.47'
L2	S 44°04'38" E	111.46'
L3	S 28°56'35" E	48.13'
L4	N 23°03'57" W	20.00'
L5	S 36°51'59" E	20.00'
L6	N 45°13'03" E	255.41'
L7	N 76°26'00" E	36.89'
L8	N 76°25'00" E	651.65'
L9	S 04°42'03" W	64.00'
L10	S 03°03'57" W	77.40'
L11	S 07°09'38" E	84.20'
L12	S 05°12'34" E	154.62'
L13	N 20°21'30" W	419.41'
L14	N 42°59'45" W	123.00'
L15	N 42°59'45" W	191.69'
L16	N 38°44'45" W	164.26'
L17	S 38°44'45" E	164.26'
L18	S 42°59'45" E	187.78'
L19	S 42°59'45" E	132.97'
L20	S 20°21'30" E	424.42'
L21	N 59°42'04" W	18.84'
L22	N 54°13'20" W	51.19'
L23	N 36°01'36" W	36.43'
L24	N 62°23'53" W	53.16'
L25	N 64°11'44" W	46.23'
L26	N 61°24'51" W	47.14'
L27	N 64°13'59" W	46.01'
L28	N 61°11'46" W	49.93'
L29	N 66°20'18" W	52.16'
L30	N 81°48'16" W	54.19'
L31	N 76°05'23" W	46.63'
L32	N 69°54'05" W	54.14'
L33	N 74°04'08" W	50.51'
L34	N 75°37'47" W	50.64'
L35	N 83°04'34" W	55.98'
L36	N 81°33'58" W	51.93'
L37	N 69°14'51" W	51.40'
L38	N 28°18'49" W	40.13'
L39	N 44°29'09" W	15.17'
L40	N 28°56'35" W	112.53'
L41	S 76°25'00" W	649.37'

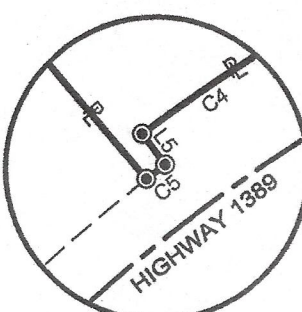

DETAIL 'A'
NOT TO SCALE

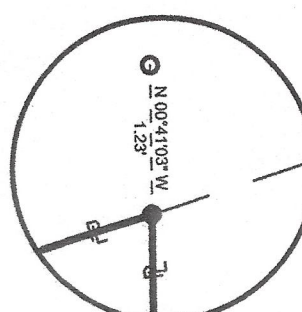

DETAIL 'B'
NOT TO SCALE

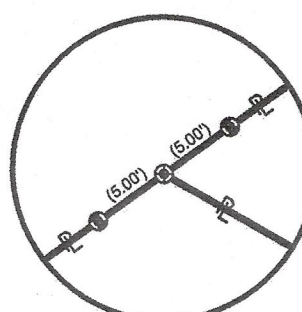

DETAIL 'C'
NOT TO SCALE

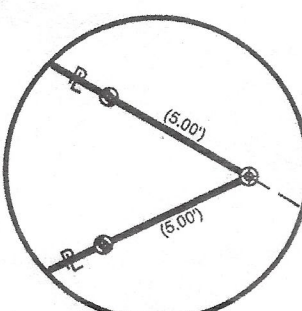

DETAIL 'D'
NOT TO SCALE

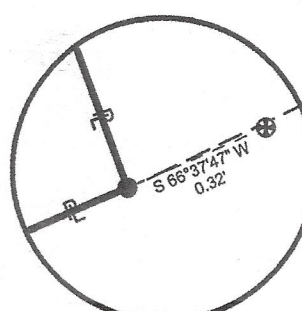

DETAIL 'E'
NOT TO SCALE

CECIL FARMS LANDS, LLC.
D.B. 863, PG. 638
PARCEL NO. 109-62
ZONED: A-R

TRACT 8
49.329 ACRES

TRACT 9
6.739 ACRES

JOSEPH W. MILLS
VICKI H. MILLS, ET AL.
D.B. 882, PG. 952
P.B. 27, PG. 207
PARCEL NO. 109-49-1
ZONED: A-R

FREDDIE J. CRAIG
MARTHA N. CRAIG
D.B. 938, PG. 864
PARCEL NO. 96-14
ZONED: A-R

SURVEYOR'S CERTIFICATION

I DO HEREBY CERTIFY THAT SHOWN HEREON IS A TRUE AND CORRECT REPRESENTATION OF A SURVEY PERFORMED UNDER MY DIRECTION BY THE METHOD OF RANDOM CLOSED TRAVERSE, OF WHICH THE UNADJUSTED MATHEMATICAL ERROR OF CLOSURE RATIO WAS 1:228,610 WITH AN ANGULAR ERROR OF 00°00'01" AND HAS NOT BEEN ADJUSTED ALONG WITH 60% OF THE SURVEY BEING RTK: GPS MEASUREMENT USING DUAL FREQUENCY TRIMBLE GNSS R8 EQUIPMENT, OF WHICH THE UNADJUSTED POSITIONAL ACCURACY OF EACH MONUMENT IS +/- 0.05 FEET+100PPM AND HAS NOT BEEN ADJUSTED. THE BEARINGS SHOWN HEREON ARE TIED TO KENTUCKY STATE PLANE COORDINATES (KY SOUTH ZONE 1602). THE SURVEY IS CLASSIFIED AS AN URBAN SURVEY AND MEETS ALL OF THE ACCURACY AND PRECISION SPECIFICATIONS FOR THAT CLASS AND IS CORRECT TO THE BEST OF MY KNOWLEDGE AND BELIEF. I ALSO CERTIFY THAT ALL MONUMENTS INDICATED HEREON DO ACTUALLY EXIST AND THAT THEIR LOCATIONS, SIZES, AND MATERIALS ARE CORRECTLY INDICATED. THE SURVEY COMPLIES WITH 201 KAR 18:150.

[Signature]
J. WILLIAM WEIKEL, JR., KY PLS NO. 2813
DATE: July 30, 2019